

Package Details

DPAK Rectifier Case

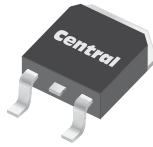

Mechanical Drawing

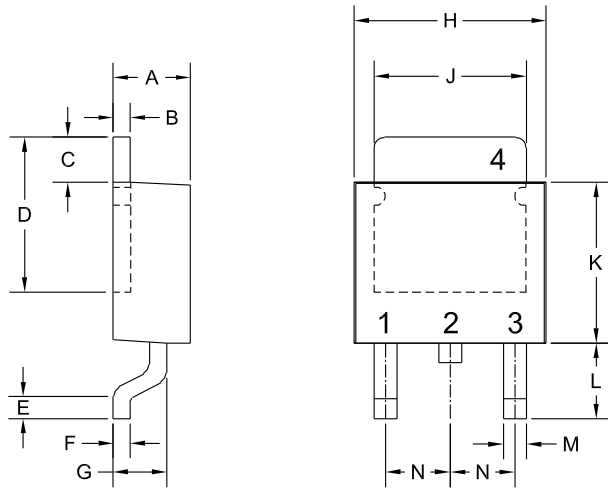

SYMBOL	DIMENSIONS			
	INCHES		MILLIMETERS	
	MIN	MAX	MIN	MAX
A	0.083	0.108	2.10	2.75
B	0.016	0.024	0.40	0.60
C	0.063		1.60	
D	0.203	0.219	5.15	5.55
E	0.039		1.00	
F	0.020		0.50	
G	0.051	0.071	1.30	1.80
H	0.248	0.268	6.30	6.80
J	0.197	0.217	5.00	5.50
K	0.209	0.224	5.30	5.70
L	0.090	0.106	2.30	2.70
M	0.012	0.031	0.30	0.80
N	0.091		2.30	

DPAK RECTIFIER (REV: R2)

Lead Code:
Reference individual device datasheet.

R2 **Part Marking:** Full Part Number

Mounting Pad Geometry (Dimensions in mm)

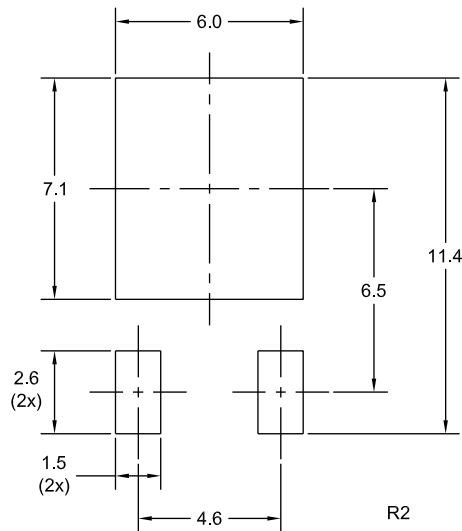

R2

Package Details

DPAK Rectifier Case



Tape Dimensions and Orientation (Dimensions in mm)

Tape Width: 16mm

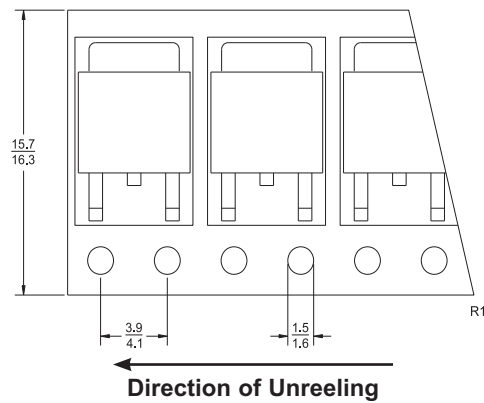

Devices are taped in accordance with Electronic Industries Association Standard EIA-481-2-A

Packaging Base

13" Reel = 2,500 pcs.

Reel Labeling Information

Each reel is labeled with the following information:

Central Part Number, Customer Part Number, Purchase Order Number, Quantity, Lot Number, Date Code and Ship Date.

Reel Packing Information

Reel Size	Reels per Box (Maximum)	Parts per Box (Maximum)	Box Dimensions		Shipping Weight (Max.)	
			INCH	CM	LB	KG
13"	4	10,000	15x4x15	38x10x38	12	6
	9	22,500	15x15x9	38x38x23	25	12
	18	45,000	15x15x18	38x38x46	49	23

Ordering Information

- For devices taped and reeled on 13" reels, add TR13 suffix to part number.
- All SMDs are available in small quantities for prototype and manual placement applications.

R4 (4-March 2010)

Material Composition Specification

DPAK Case

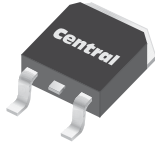

Device average mass 297 mg
 Fluctuation margin +/-10%

Component	Material	Material		Substance	CAS No.	Substance		
		(%wt)	(mg)			(%wt)	(mg)	(ppm)
active device	doped Si	0.75%	2.23	Si	7440-21-3	0.75%	2.23	7,508
leadframe	Cu alloy	52.54%	156	Cu	7440-50-8	52.46%	155.8	524,570
				Fe	7439-89-6	0.08%	0.24	808
die attach	high temperature solder paste	5.12%	15.2	Pb	7439-92-1	4.73%	14.06	47,339
				Sn	7440-31-5	0.26%	0.76	2,559
				Ag	7440-22-4	0.13%	0.38	1,279
encapsulation*	EMC	38.7%	115	silica	7631-86-9	26.33%	78.2	263,255
				epoxy resin	29690-82-2	7.74%	23.0	77,428
				phenol resin	9003-35-4	3.87%	11.5	38,690
				Sb ₂ O ₃	1309-64-4	0.38%	1.14	3,838
				Br	7726-95-6	0.38%	1.14	3,838
	EMC GREEN	38.7%	115	silica (fused)	60676-86-0	29.8%	88.5	297,975
				epoxy resin	29690-82-2	3.87%	11.5	38,720
				phenol resin	9003-35-4	3.76%	11.16	37,575
				carbon black	1333-86-4	0.12%	0.345	1,162
				metal hydroxide	1309-42-8	1.16%	3.45	11,616
plating**	tin/lead process	2.89%	8.58	Sn	7440-31-5	2.6%	7.72	25,993
				Pb	7439-92-1	0.29%	0.86	2,896
	matte tin	2.89%	8.58	Sn	7440-31-5	2.89%	8.58	28,888

*EMC GREEN molding compound is Halogen-Free.

**For Lead Free plating, add suffix "LEAD FREE" to part number.

For Tin/Lead plating, add suffix "TIN/LEAD" to part number.

No suffix designation allows for the supply of either lead-free or tin/lead plated product depending on availability.

Disclaimer

The information provided in this Material Composition data sheet is, to the best of our knowledge, correct. However, there is no guarantee to completeness or accuracy, as some information is derived from data sources outside the company.

R2 (3-June 2011)